

5. ENGINE REMOVAL/INSTALLATION

5

ENGINE REMOVAL/INSTALLATION

SCHEMATIC DRAWING	5-1
SERVICE INFORMATION	5-2
ENGINE REMOVAL	5-3
ENGINE INSTALLATION	5-5

5. ENGINE REMOVAL/INSTALLATION

SCHEMATIC DRAWING

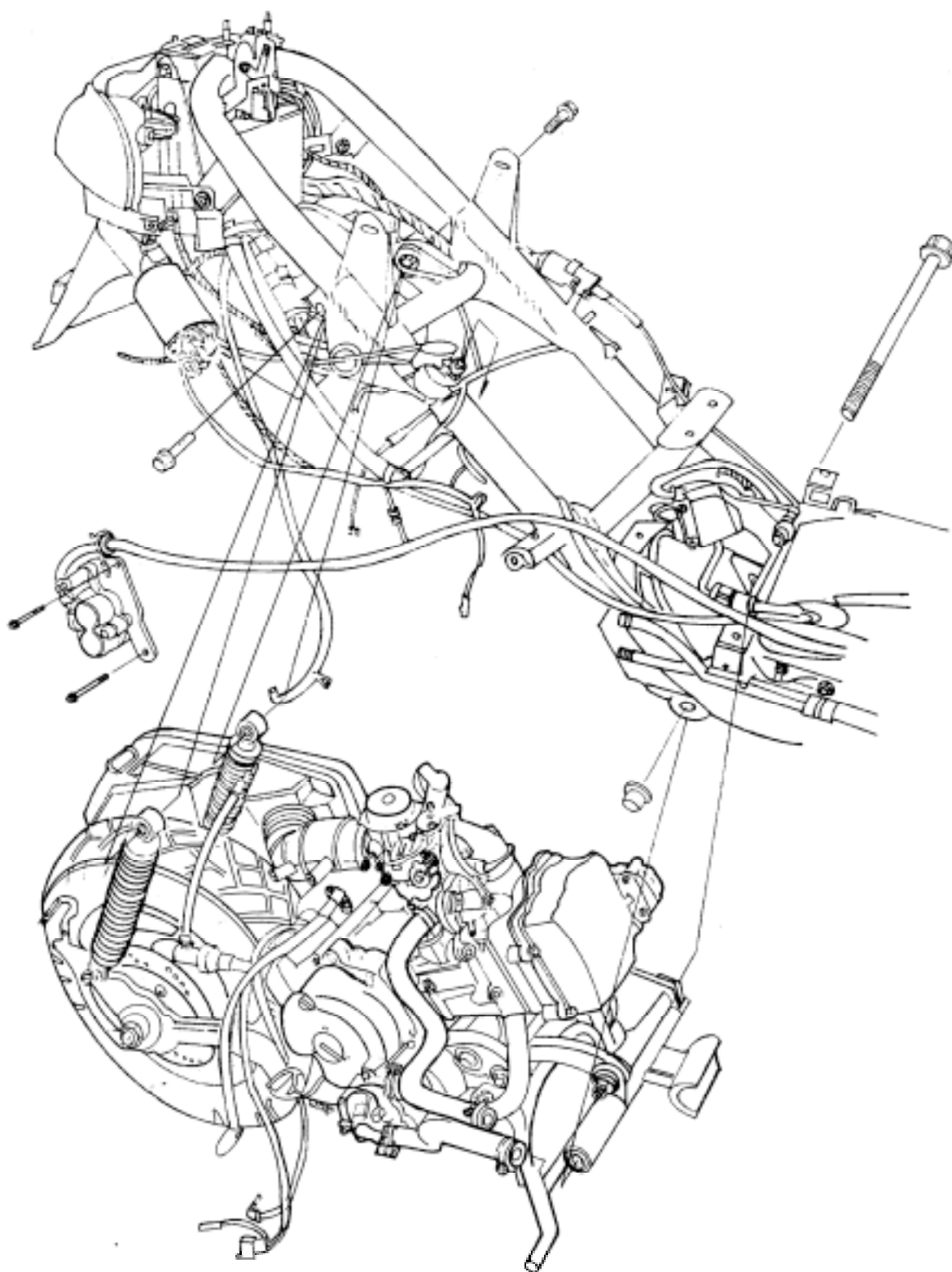

SERVICE INFORMATION

- A floor jack or other adjustable support is required to support and maneuver the engine. Be careful not to damage the motorcycle body, cables and wires during engine removal.
- Use shop towels to protect the motorcycle body during engine removal.
- Drain the coolant before removing the engine.
- After the engine is installed, fill the cooling system with coolant and be sure to bleed air from the water jacket. Start the engine to check for coolant leaks.
- Before removing the engine, the rear brake caliper must be removed first. Be careful not to bend or twist the brake fluid tube.

Total capacity	: 1400±20cc
Radiator capacity	: 1000±20cc
Reserve tank capacity	: 400±20cc

Engine mounting bolt	49N-m
Rear shock absorber upper mount bolt	39.2N-m

5. ENGINE REMOVAL/INSTALLATION

ENGINE REMOVAL

Disconnect the battery negative cable.
 Remove the frame body cover. (⇒2-3)
 Disconnect the engine negative cable.
 Disconnect all of the A.C. generator, auto
 bystarter, spark plug, thermosensor wire
 couplers and connectors.
 Disconnect the engine fuel tube.
 Drain the coolant. (⇒3-9)
 Disconnect the water hose.

Wire Connectors

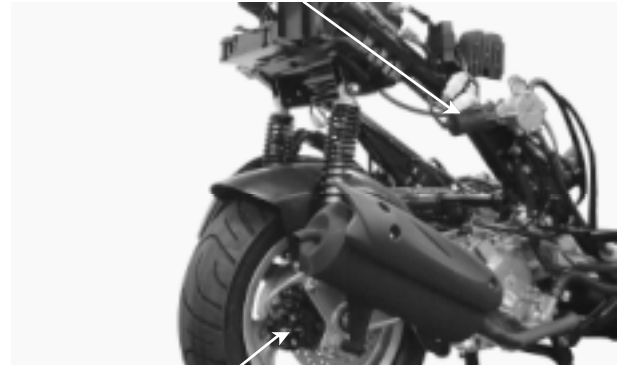

Rear Brake Caliper

Disconnect the starter motor wire that goes to
 the starter relay.

Starter Relay

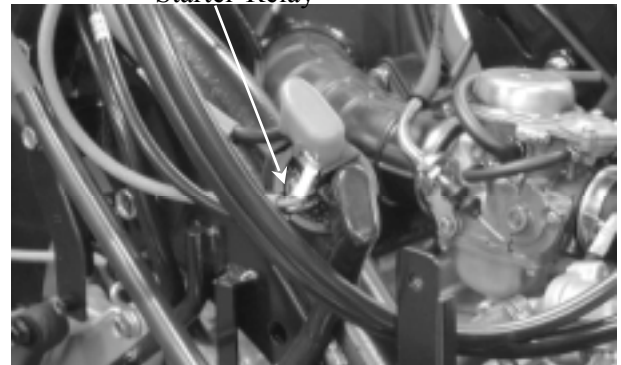

Disconnect the fuel tube and vacuum tube
 that go to the carburetor from the fuel pump.
 Disconnect the vacuum tube from the air cut-
 off valve (ACV).
 Disconnect the throttle cable from the
 carburetor.

Throttle Cable

Fuel Tube

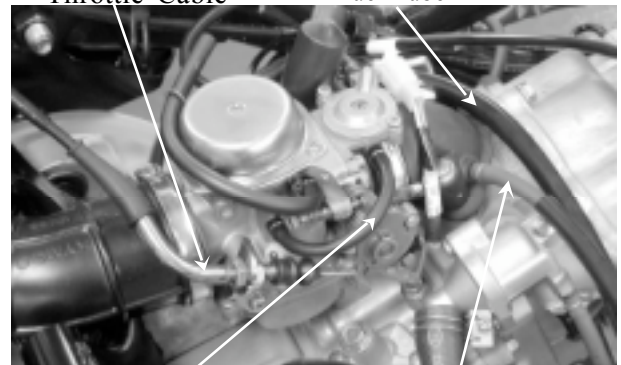

ACV Vacuum Tube

Fuel Pump Vacuum Tube

Remove the brake fluid tube bolt of the rear
 brake caliper.
 Remove the rear brake caliper bolt and the
 rear brake caliper.

Brake Fluid Tube

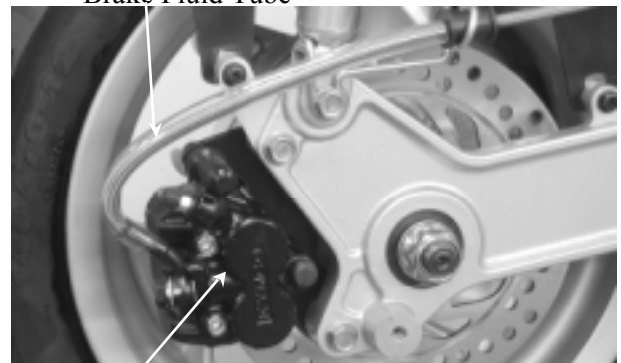

Rear Brake Caliper

5. ENGINE REMOVAL/INSTALLATION

Remove the right/left rear shock absorber upper mount bolts.

Rear Shock Absorber Upper Mount Bolts

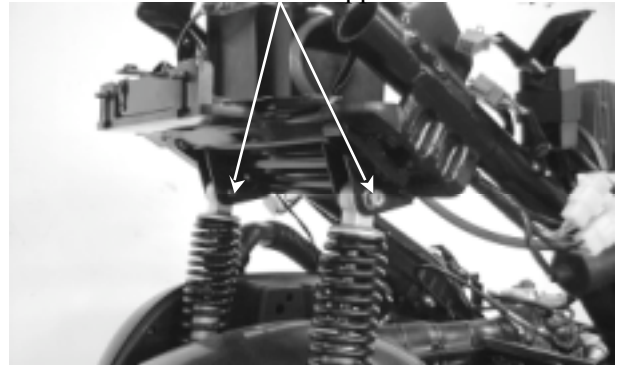

Remove the two engine mounting bolts and pull out the engine with the engine hanger backward.



Engine Hanger Bolt

ENGINE HANGER REMOVAL

Remove the engine hanger bolts to remove the engine hanger.



Bolt

Engine Hanger

Inspect the engine hanger bushings and stopper rubber for wear or damage.

Stopper Rubber

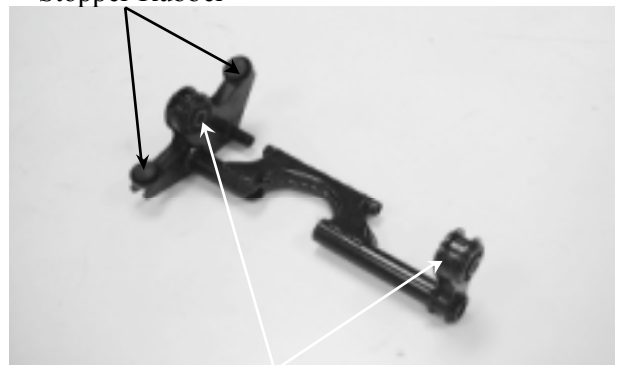

Bushings

5. ENGINE REMOVAL/INSTALLATION

ENGINE INSTALLATION

Install the engine in the reverse order of removal.

Tighten the engine mounting bolts.

Torque: 49N-m

Tighten the rear shock absorber upper mount bolts.

Torque: 39.2N-m

After installation, inspect and adjust the following:

- Throttle grip free play (⇒3-3)
- Fill the rear brake reservoir with brake fluid and bleed air from the rear brake.
- Fill the cooling system with coolant and start the engine to bleed air from the system.

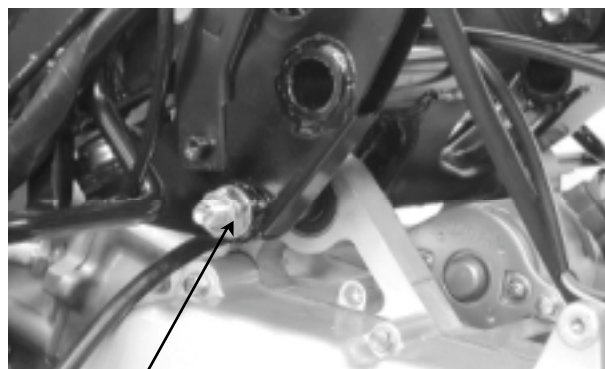

Engine Hanger Bolt

Rear Shock Absorber Upper Mount Bolts

